



Explora
LED Driving Lights
US Specification

Thank you for choosing VISIONX
We know you would rather be driving your vehicle than wrenching on it, so we go the extra mile to make sure our instructions are clear and as easy to understand as possible. If you have any questions, comments, or suggestions don't hesitate to give our gear experts a call at +1 253 338 8716 or visit WWW.VISIONXOFFROAD.COM

Please Read Before Installing
VISIONX products should always be installed by a qualified technician. If you are unsure of your ability to properly install a product, please have the product installed by your local dealer. VISIONX takes no responsibility for damages caused by improper installation. **Caution:** When installing electronics it is extremely important to pay close attention to how wires are routed.

Installation Tips
We strongly recommend using medium strength liquid thread locker on all screws, nuts, and bolts. It is also important to ensure that all hardware is tightened to the proper torque specifications as listed in your owner's manual. For included accessory hardware please refer to the default torque specifications provided below. Inspect all hardware after the first 30 miles to ensure proper torque specifications are maintained.

Bolt Size	in-lbs	ft-lbs	Nm
M3	10.0 in-lbs	-	1.0 Nm
M4	23.0 in-lbs	-	2.5 Nm
M5	44.5 in-lbs	3.5 ft-lbs	5.0 Nm
M6	78.0 in-lbs	6.5 ft-lbs	9.0 Nm
M8	-	13.5 ft-lbs	18.0 Nm
M10	-	30.0 ft-lbs	41.0 Nm
M12	-	52.0 ft-lbs	71.0 Nm

Hardware Sizing Guide
Not sure what size bolt you have? Use this ruler to measure screws, bolts, spacers, etc. Remember, the length of a screw or bolt is measured from the start of the "mounting surface" to the end of the screw, so only include the screw head when measuring countersunk screws.

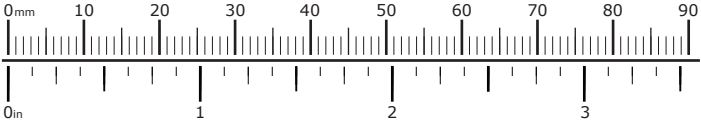

VISION X Explora Series Driving Light Pods



4" Driving Light Pod
EX-DL12S



6" Driving Light Pod
EX-DL24S



7" Driving Light Pod
EX-DLX24S

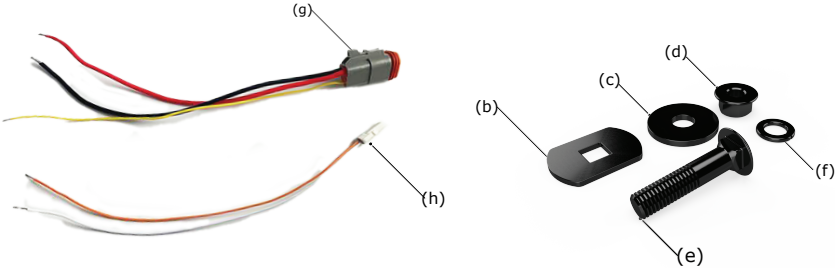

Kit Contents

- (a) Explora Driving Light Pod With Smoked Lens Included.....

Qty 1
- (b) Oval Washer.....

Qty 1
- (c) M10 Washer.....

Qty 1
- (d) M10 Flange Nut.....

Qty 1
- (e) M10 x 45mm Round Head Square Neck Bolt.....

Qty 1
- (f) M10 Split Lock Washer.....

Qty 1
- (g) 6 Pin Wiring Pigtail.....

Qty 1
- (h) 2 Pin Wiring Pigtail.....

Qty 1

1. Mounting The Lights

WWW.VISIONXOFFROAD.COM

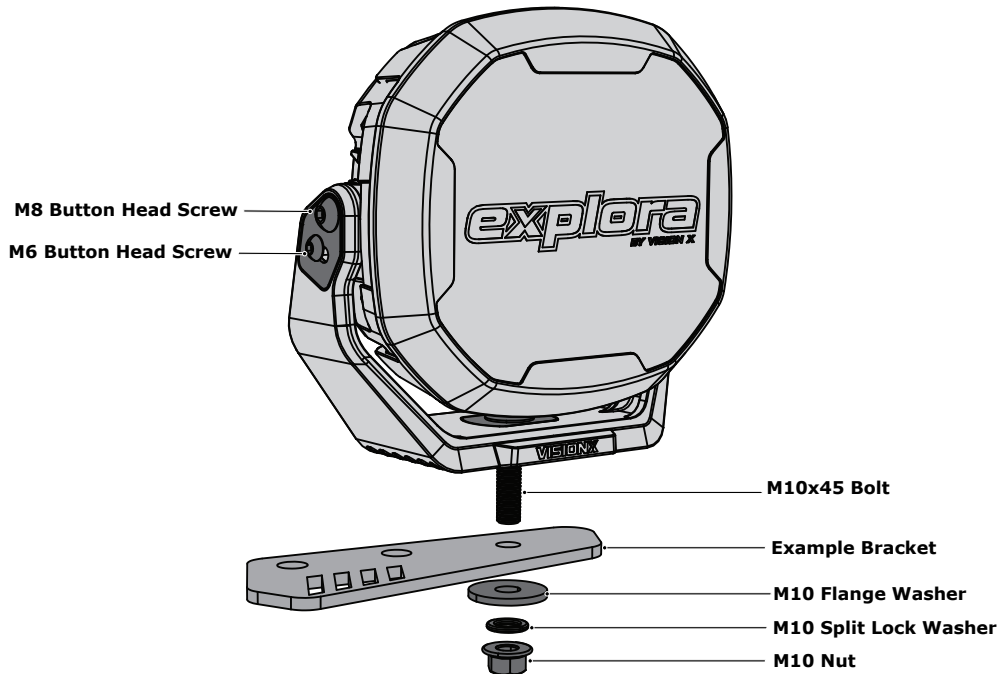

1.1 - Mounting The Light

Step One: Align the M10 bolt with the hole on the mounting bracket and secure it in place from below with the included Flange washer, Split lock washer and M10 Nut.

1.2 - Mounting The Light

Step Two: When the light Pod is aimed left-right and properly torqued down, final up-down aiming can be adjusted by loosening the Button Head screws found on each side of the Pods Mounting Bracket. Re-tighten these screws after the desired aim is achieved.

2. Lens Cover & Trim Ring

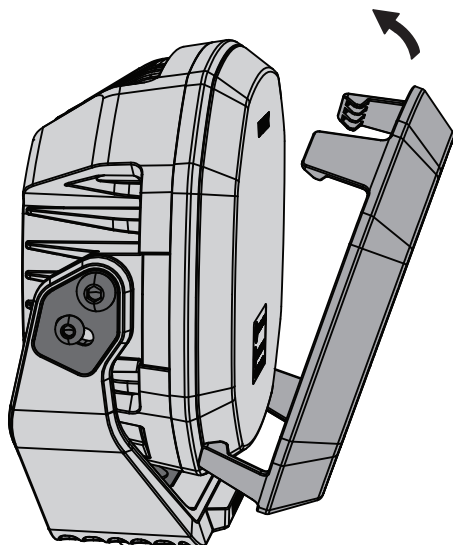

2.1 - Installing The Lens Cover

Step One: Start with either the top or bottom mounting tabs and hook them onto the light pod, reaching passed the colored trim ring.

Step Two: Rotate the other tabs over the center of the light pod face. These tabs will flex slightly and snap securely into place.

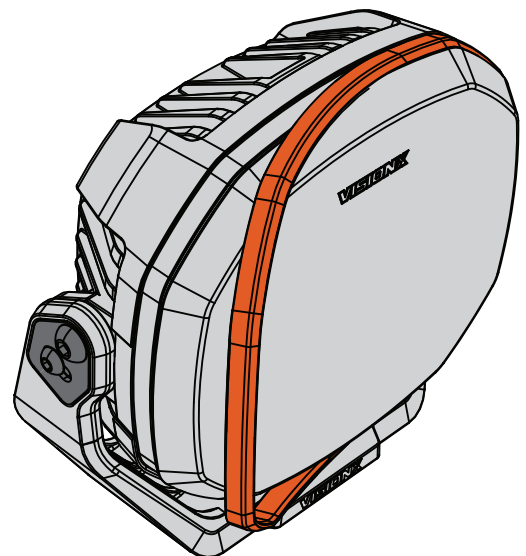

2.2 - Swapping The Trim Ring

Step One: Pick an edge and peel off the currently installed silicone trim ring. Pry the band forward to release it from the channel surrounding the light housing.

Step Two: Choose a new trim ring color and reinstall the band. The flat face of the trim ring will sit against the light housing and the chamfered edge will face out towards the lens. There is a small key cutout on the bottom backside of the trim ring that lines up with a tab in the center of the lower half of the channel.

3. Position Light Functions



3.1 - Position Light Overview

Note: In addition to the main driving light function, the Explora series has two colors of position lights built in (white & Amber).

Step1: Choose either the white or amber color position light (white or orange wire) and connect it to a constant power source, ie. the vehicles DRL circuit.

3.2 - Switchback Functionality

Note: The position lights have switchback turn signal functionality and can be wired to flash with the vehicles turn signal. The orange circuit will take priority over the white circuit while turn is active and switch back to white when turn is canceled.

Step1: Connect the white circuit to a constant power source like the vehicles DRL.

Step2: Connect the orange circuit to the vehicles turn signal.

4. Light Connector Pinout

Wire Function:

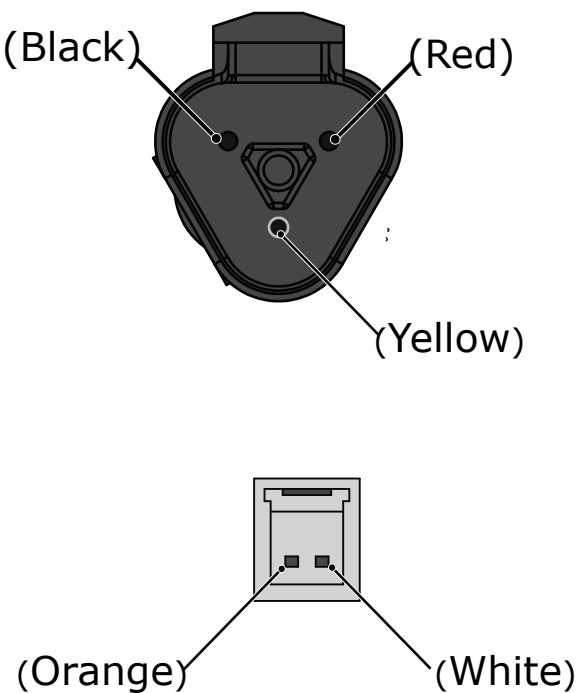
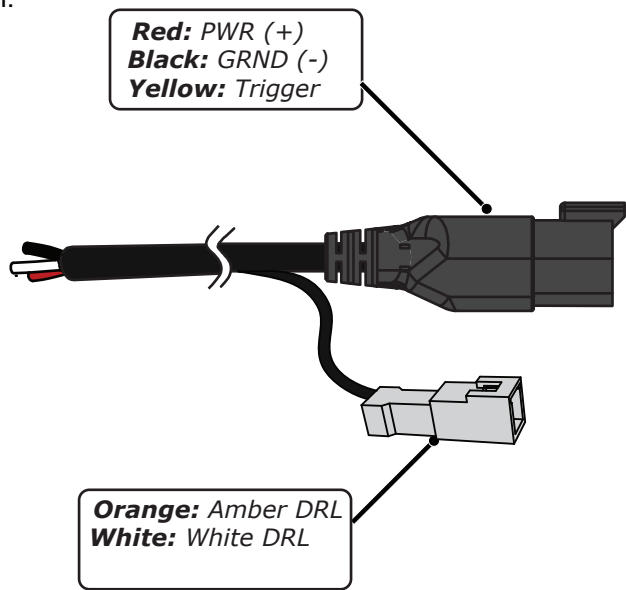

4.1 - Wire Harness Pinout

Note: The table above shows the wire color and associated function tied to it as well as the pin location within the plug at the end of the Lights harness.

5. Wiring Harness

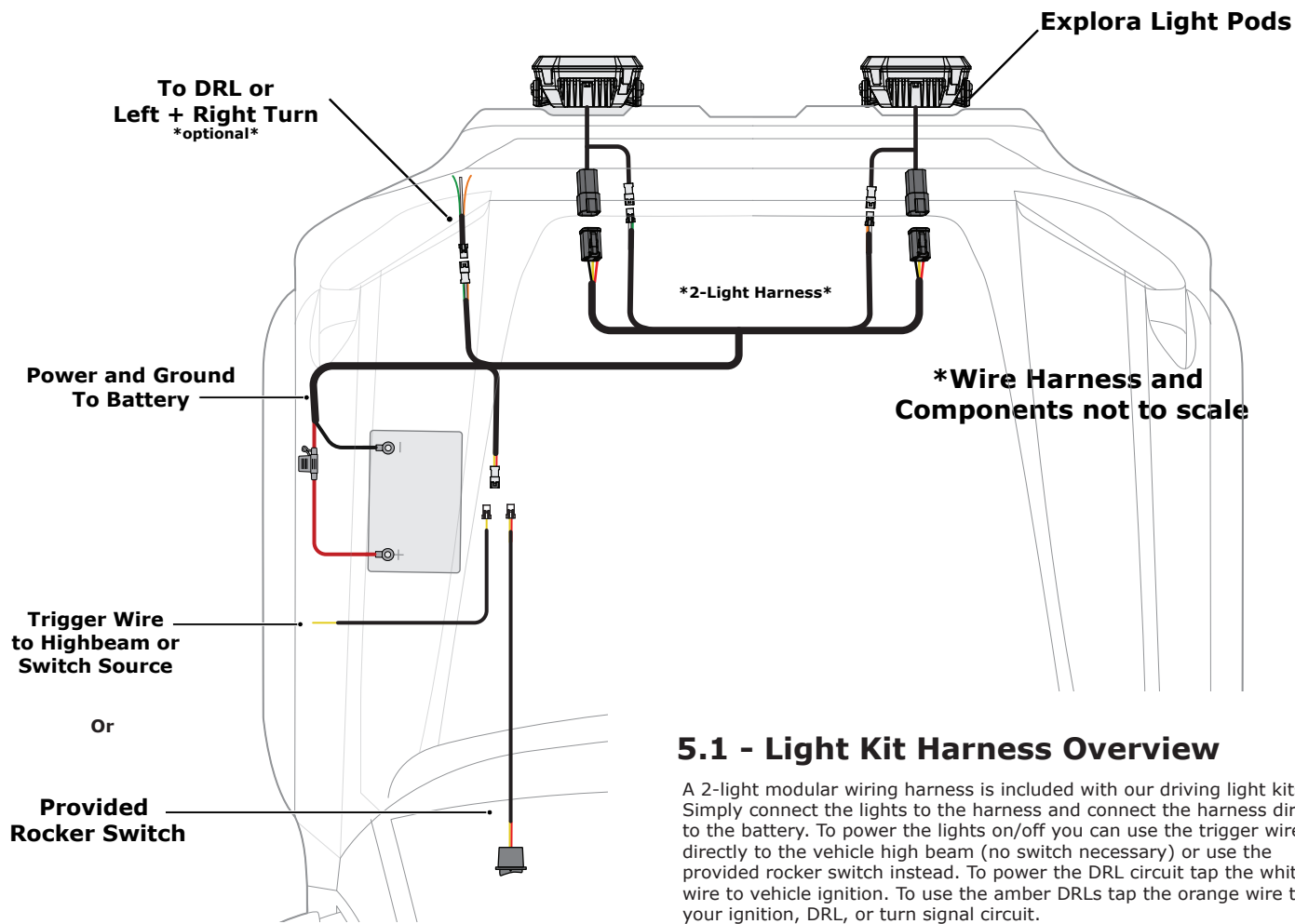

5.1 - Light Kit Harness Overview

A 2-light modular wiring harness is included with our driving light kits. Simply connect the lights to the harness and connect the harness direct to the battery. To power the lights on/off you can use the trigger wire directly to the vehicle high beam (no switch necessary) or use the provided rocker switch instead. To power the DRL circuit tap the white wire to vehicle ignition. To use the amber DRLs tap the orange wire to your ignition, DRL, or turn signal circuit.

6. Technical Specifications

Specification	4" Light Pod	6" Light Pod	7" Light Pod
Part Number:	EX-DL12S	EX-DL24S	EX-DLX24S
LED / Color Temp:	(12) 3.75W / 5700°K	(24) 2.67W / 5700°K	(24) 5W / 5700°K
Watts / Amps:	45W / 3.75A	64W / 5.33A	80W / 6.7A
Lumens:	3295lm	6000lm	8160lm
Beam Pattern:	Hybrid Beam	Hybrid Beam	Hybrid Beam
Operating Temp:	-40°C ~ 80°C	-40°C ~ 80°C	-40°C ~ 60°C
IP Rating:	IP68/IP69K	IP68/IP69K	IP68/IP69K
Vibration Rating:	ISO 16750-3	ISO 16750-3	ISO 16750-3
Warranty:	Limited Lifetime	Limited Lifetime	Limited Lifetime